

TWIST
CURVED END
CAP

product set up instructions

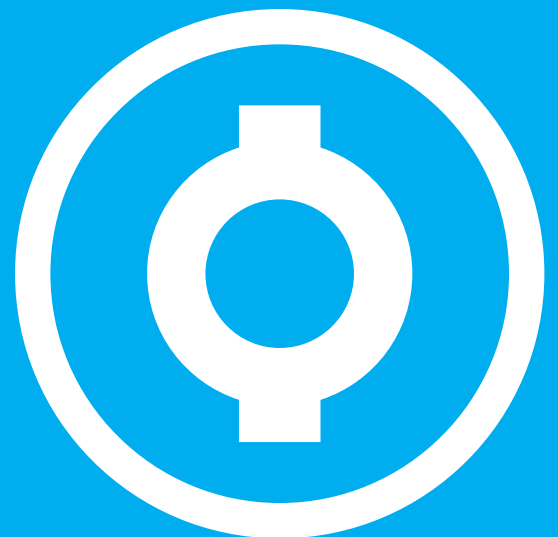

Twist Curved End Cap Setup Instructions

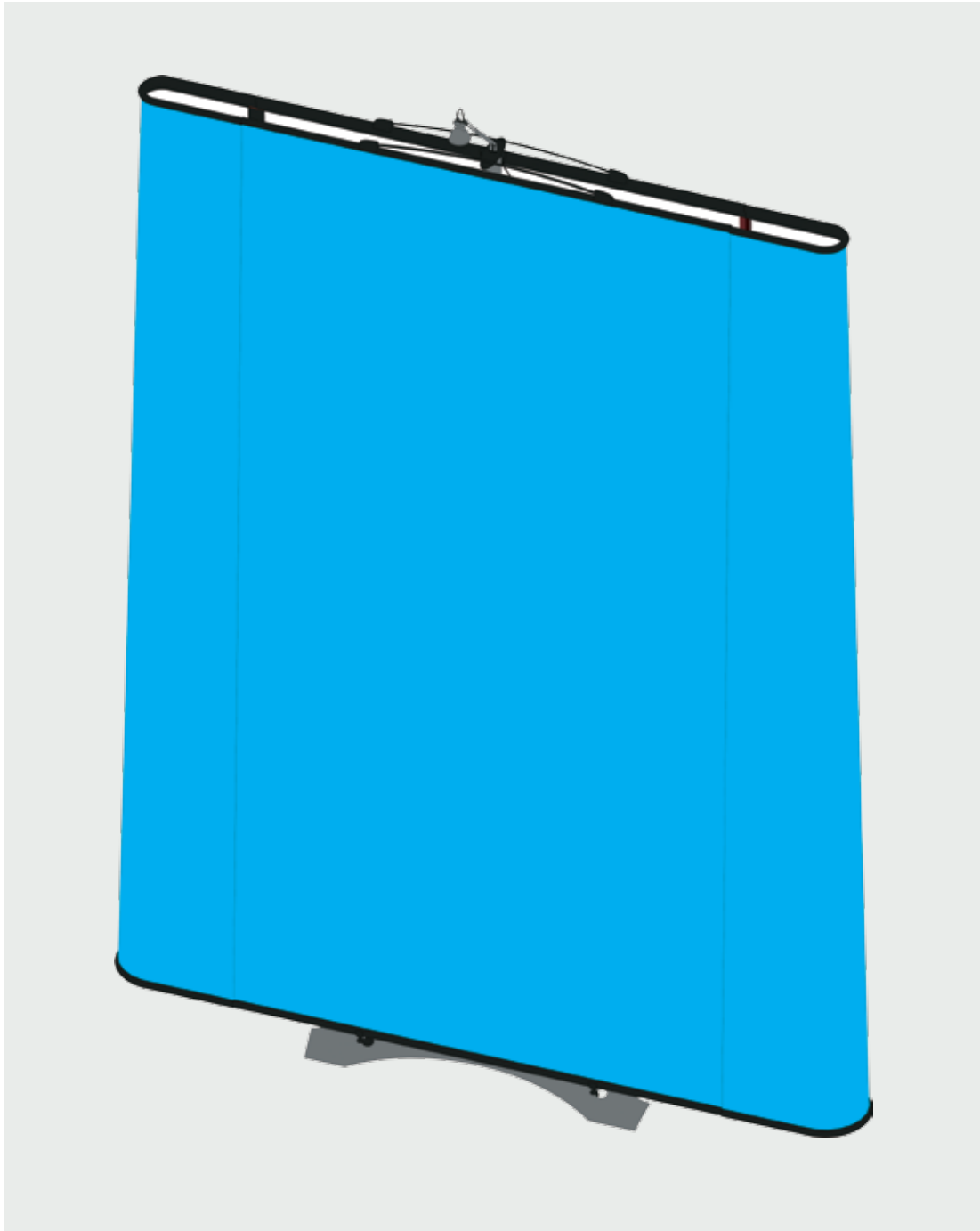

Part 1

Twist Curved End Cap Setup Instructions

Items

6x magnetic bars, endcap graphic panel, complete double sided Twist stand.

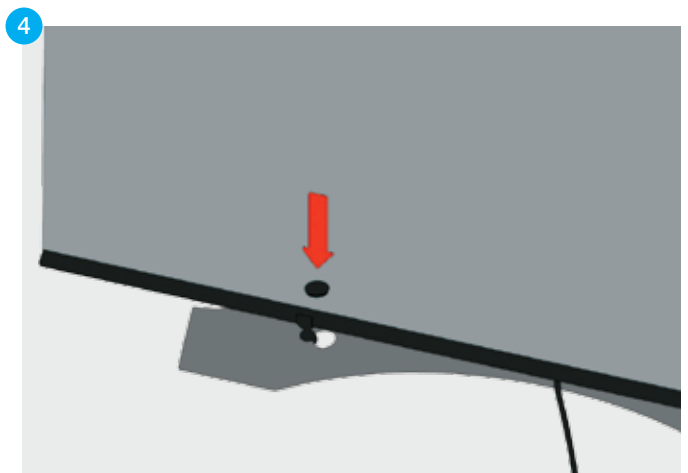
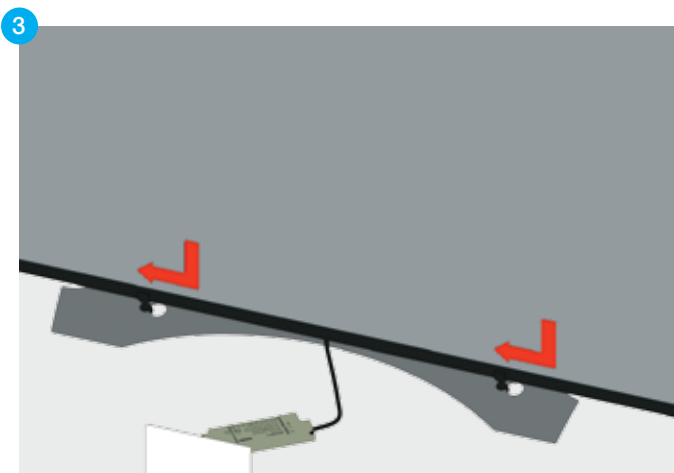
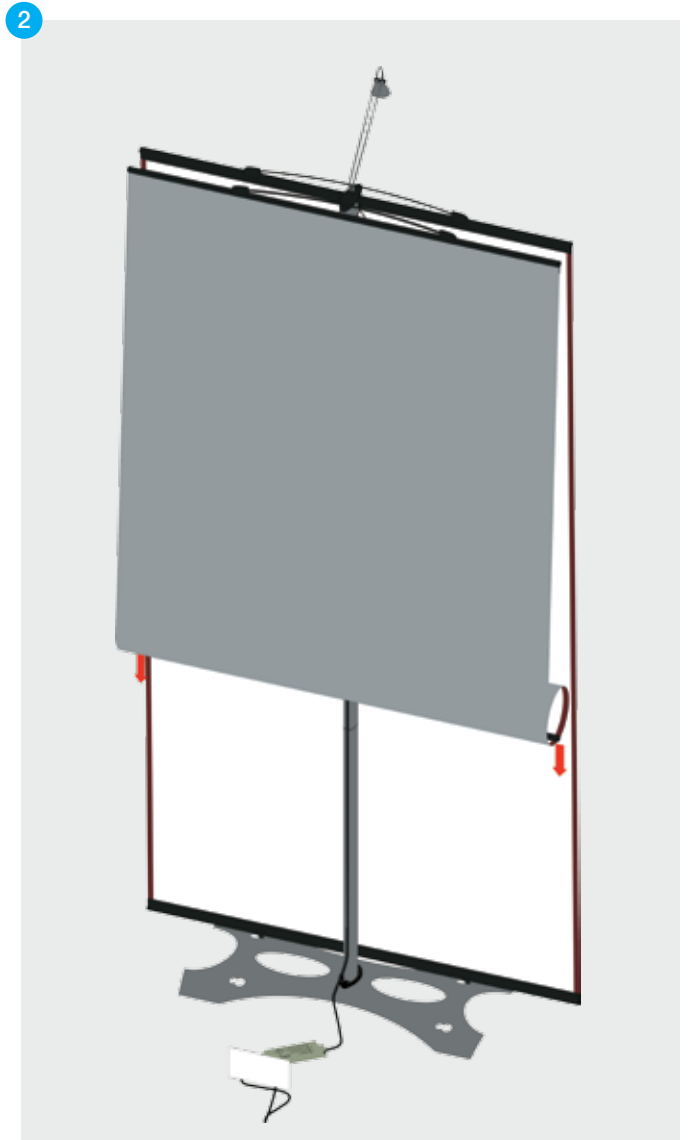
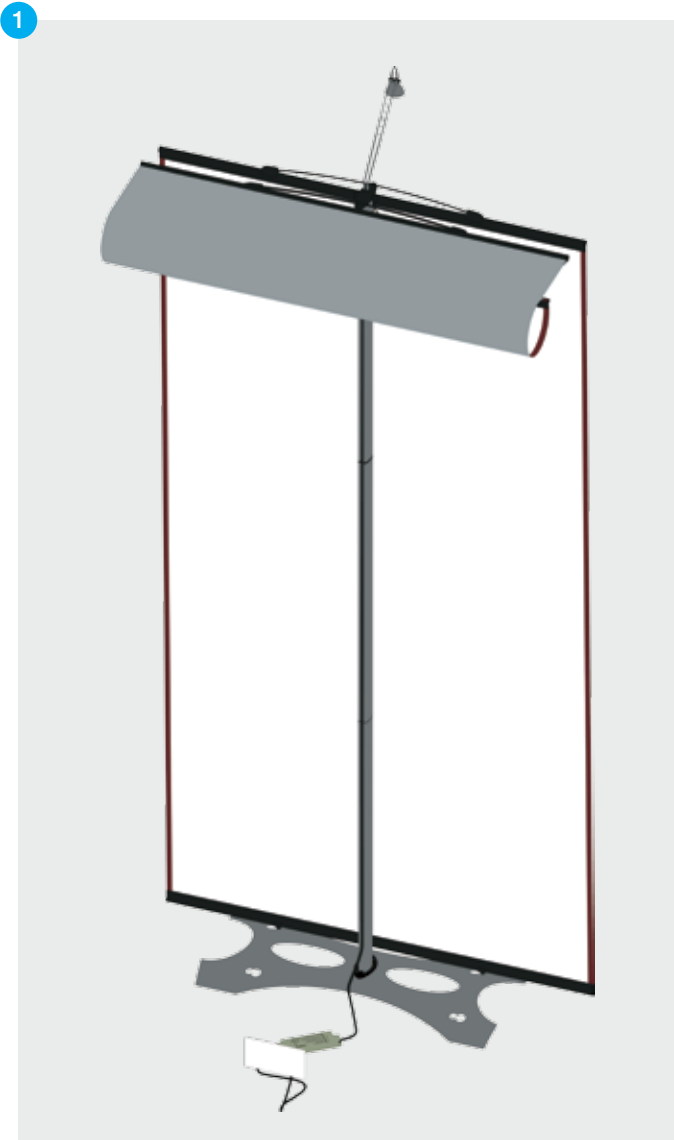

Twist Curved End Cap Setup Instructions

Attach magnetic bars to Twist graphics first, leaving half of magnetic bar showing.

